

Patio Door Installation Instructions – April 2012

Parts list – 2 boxes total	
Box 1	2 each patio door panels 1 each sliding screen door
Box 2	1 each patio door frame 1 hardware pack

PLEASE READ ALL INSTRUCTIONS BEFORE BEGINNING INSTALLATION.

These guidelines are provided in good faith to help prevent installation problems caused by common errors. A&B Accessories bears no responsibility for installation actions taken or not taken. There are many nuances of installation that A&B Accessories assumes are general construction knowledge to an experienced installer; such nuances are not included in these instructions. Rather, these installation guidelines are strictly recommendations, not intended to serve as a step-by-step, foolproof installation checklist. Selection of an experienced installer is the sole responsibility of the project owner. If you have any questions about installation techniques for your particular project, please call 479-839-2736.

Ensure opening is level, plumb and square before installing door frame.

Open frame box and lay out frame set on smooth, soft surface. Assemble frame using #8 x 3/4 truss head screws as in as illustrated in drawing #1

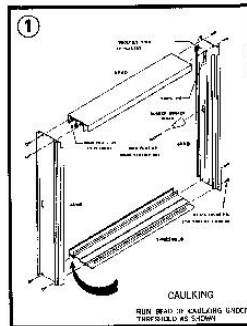

LEVEL THRESHOLD and shim as required. Caulk screw holes. Threshold must be FLAT and LEVEL for proper operation of unit (Fig. 4).

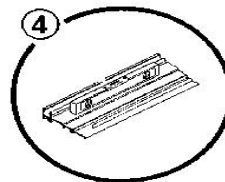

Square and plumb the vertical jamb rails to the threshold. Secure jambs using #10 x 2" flat head wood screws. (Fig. 5).

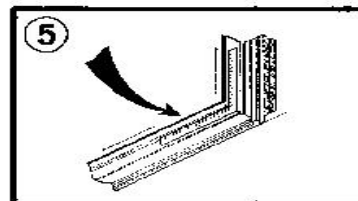

Install rubber bumper in center of jamb (use screw hole above cover latch. Bumper will cover strike latch opening.

Panel Installation for 2 Panel Door

SECURE fixed panel sill anchor to vertical stile with #8 1/2" truss head self-tapping screw. Be sure anchor is secured to the stile that will occur at the center of the door (Fig. 1).

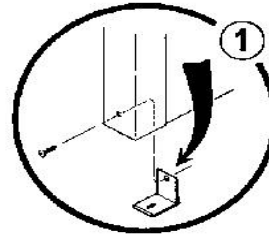

INSERT FIXED PANEL up into the middle channel of the frame at the head and lower into the THRESHOLD RECESS. Slide panel as far as possible into the jamb pocket. #2

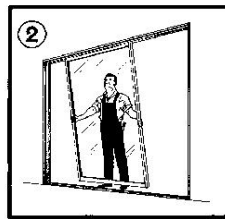

SECURE head anchor to head and secure sill anchor to threshold with #8 x 1/2" truss head self-tapping screws (Fig. 3).

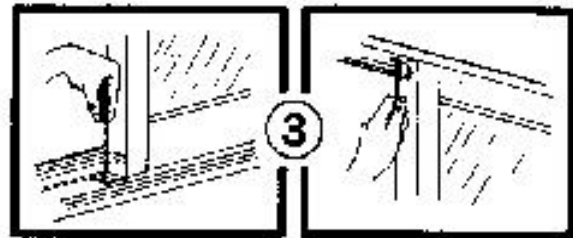

INSERT OPERATING PANEL into head and lower onto the threshold track. MAKE SURE vinyl sweeps are clear of track (Fig. 4)

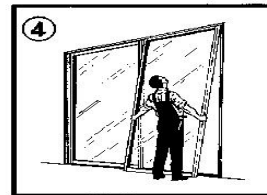

ADJUST ALIGNMENT of sliding panel by using adjustment screws in rollers at bottom (both sides) for correct alignment of operating panel with frame (Fig. 5).

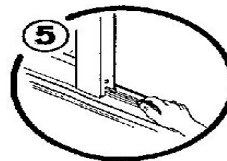

Install rubber bumpers into lock stile (Fig 6).

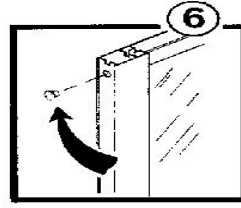

Install handle set as shown (Fig. 7).

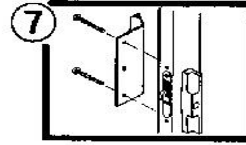

ADJUST LOCK THROW so lock engages frame properly (Fig. 8).

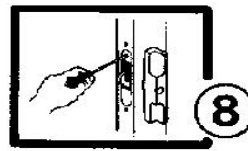

FRAME MUST BE SET PLUMB AND LEVEL TO ASSURE PROPER FUNCTIONING OF SLIDING PANELS.

NOTE: If operating panel will not close completely, loosen anchor screws in head and threshold (see figure 3) and pull fixed panel away from jamb slightly. There will be no loss of weathering ability. Tighten screws after adjustment is made.

Screen Installation

Screen Placement: With wheels retracted, place top of screen into top guide and lift bottom onto bottom track.

Adjusting Top and Bottom Roller Screws: Use Phillips screwdriver to adjust roller tension.